



“Balance” was the operative word when Sophie Burke and Jennifer Millar created the master bathroom in this new-build Vancouver house. The homeowners wanted the space to emulate an airy retreat – something spa-like but not too fussy. So the designers injected the room with traditional character and contemporary clean lines – a timeless combination showcased throughout the home (see “If You Build It...,” page 76), which the duo designed as well. They also incorporated equal amounts of sleek and textural elements and functional and decorative features for an interesting yet well-balanced result.



Steel-framed mirrors and simple sconces, which are actually picture lights, inject a retro-industrial vibe.



NEW SCHOOL In lieu of the usual two sinks, designers Sophie Burke and Jennifer Millar used one oversized basin with two wall-mounted faucets. “The sink is shallow enough so that the top drawers of the vanity actually open,” says one of the homeowners. Wainscoting, created out of ceramic subway tiles that continue from the shower, offers texture and character. “We used dark grout and added a chair rail detail throughout, which contribute to the space’s vintage look.”

GLASS HOUSE Forgoing a curb in the glass-enclosed shower, made possible by sloping the floor toward the drain, creates a streamlined feel. “We were able to do that because the house is a new construction,” says Sophie. This application also lets the herringbone marble-tiled floor run right through without being interrupted. “It’s a really nice detail,” she adds.

DESIGN, Sophie Burke Design, sophieburke-design.com; **CONTRACTING**, custom VANITY, Eycoc Building Group; Cloud White CC-40 **WALL PAINT**, Benjamin Moore; **WALL TILES**, Daltile; Lunch at Tiffany’s P5219-24 **VANITY PAINT**, Para Paints; **COUNTERTOP**, Caesarstone Canada; **BATHTUB, SHOWER FIXTURES**, Blu Bathworks; **SINK**, Duravit; **FAUCETS**, Newport Brass; custom **CAFÉ CURTAINS**, The Natural Textile Company; **FLOOR TILES**, Centanni Tile; **MIRRORS, KNOBS**, Restoration Hardware; **PICTURE LIGHTS**, The Urban Electric Co.; **PENDANT LIGHT**, Arteriors Home.

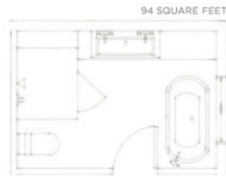

STYLEATHOME.COM SEPTEMBER 2016 | 57



STYLE AT HOME CANADA
SEPTEMBER 2016
LAMBOLL

THE URBAN ELECTRIC CO.